

# SOLENOID VALVE NAMUR Series



## Features :

- Bubble tight shut off.
- Mounts in any position.
- Suitable for high speed cycling.
- Speed upto 600 cycle / min.
- Life > 10 million cycles.
- Good Flow Characteristics



## Technical Specifications :

Model	KN-3252-CM-14		
Description	3/2 & 5/2 Combined Valve		
Operation	Internal Pilot Operation		
Orifice	6mm		
Operating pr (bar)	2 to 10		
Port Connection	1/4" BSP ( F )		
Body Material	Valve Body -Hard anodized(AL) Internal :- SS 430 F , Brass		
Seal Material	Hi-Nitrile	NBR	VITON
Voltage Range	230 VAC 6W	24 VDC 8W	
Power Consumption	6 W	8 W	
Solenoid Enclosure	Junction Box		
Cable Entry	1/2"NPT (F) Side Cable Entry		
Class of Insulation	Class F Instalation		

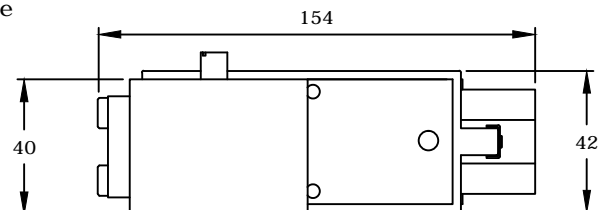
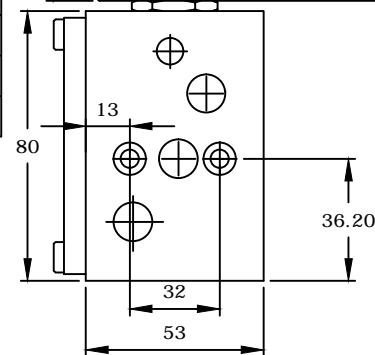
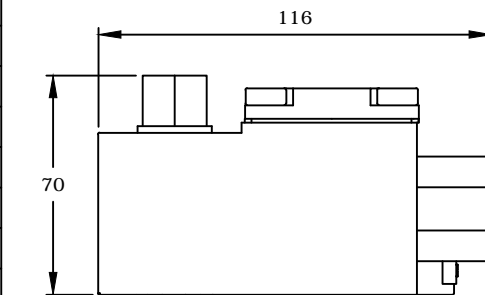

## Caution:

- A. To ensure proper functioning
  1. Please ensure that inlet port is connected to compressor air source.
  2. Exhaust should not be restricted.
- B. AC coil valve should not be used on DC coil valve and vice versa.

## Applications:

Operation of Double Acting Cylinder / Actuator.  
The pressure drop at inlet port causes malfunction of the valve. All equipment connected between the header & the inlet port should have a higher orifice compared to the solenoid valve.



Manufactured by :

**Kushako India**

Office : 490, Narayan Peth, Opp. Pune Marathi Granthalaya, Pune - 411030. (Maharashtra), Website : [www.kushakoindia.com](http://www.kushakoindia.com)

Works : Sr.No. 25/1A, Village Nanded, Sinhgad Road, Tal - Haveli, Dist. Pune -411041

Tel. No : 901169077 / 7620674777

E-mail : [kushako.india@gmail.com](mailto:kushako.india@gmail.com) / [kushakoindia1992@gmail.com](mailto:kushakoindia1992@gmail.com)